

INFORMATION

The Forged Eye Bolt sleeve anchor is a thin walled sleeve anchor suitable for use in concrete, stone, brickwork, perforated bricks and dense concrete blocks.

The diagonal slot enables the small gaps to be pulled down and a positive clamping force to be exerted through the fixture.

BASE MATERIAL

- Concrete
- Stone
- Brickwork
- Perforated Bricks
- Dense Concrete Blocks

FEATURES

- Zinc Plated And Yellow Passivated
- Minimum 5µm

RANGE DATA

RANGE AND PERFORMANCE DATA							
Part Number	Anchor Hole Size	Eye Diameter	Minimum Hole Depth	Minimum Structure Thickness	Recommended Resistance In C20/25 Concrete	Recommended Resistance In Solid Brickwork* (20 N/mm ²)	Recommended Resistance In Solid Concrete Block* (7 N/mm ²)
	mm	mm	mm	mm	kN	kN	kN
SLZE08040F	8	10	45	100	2.5	0.8	0.5
					Installation Torque (Nm)		

* Due to the variable nature of bricks and concrete blocks these figures are for guidance only.

INSTALLATION INSTRUCTIONS

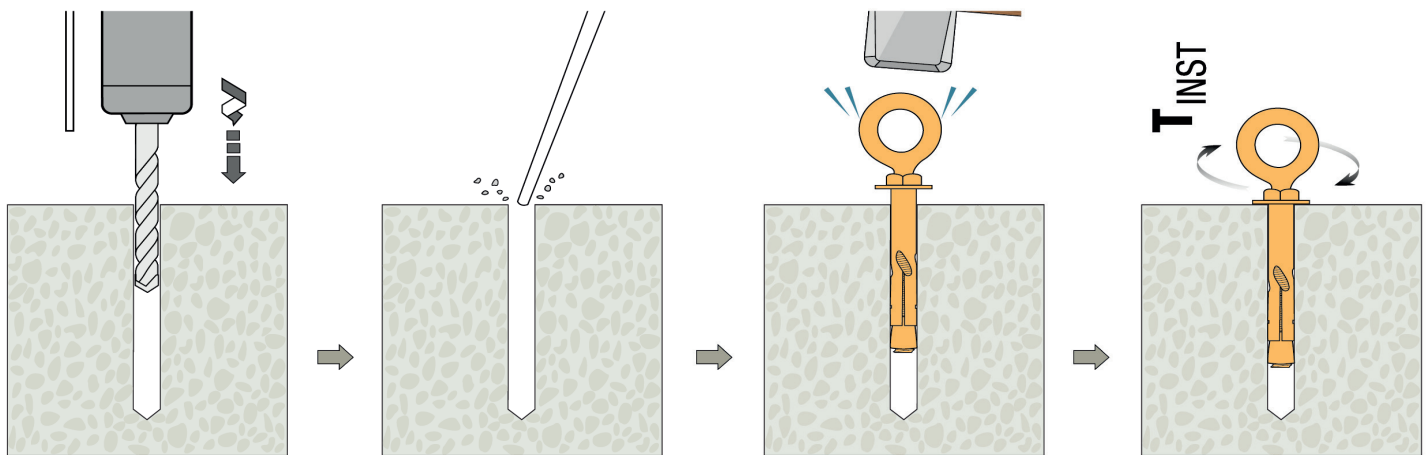

-Drill correct diameter hole to corresponding depth

-Clean hole by blowing to remove drilling debris and dust

-Insert anchor into concrete by using a suitable hammer

-Tighten with torque wrench to recommended torque

